

# DEPARTMENT OF NATURAL RESOURCES AND CONSERVATION

Trust Lands Management Division • Central Land Office • Helena  
8001 N. Montana Ave., Helena, MT 59602 Phone: (406) 458-3500 Fax: (406) 458-3506



GREG GIANFORTE, GOVERNOR

1539 ELEVENTH AVENUE

## STATE OF MONTANA

DIRECTOR'S OFFICE: (406) 444-2074  
FAX: (406) 444-2684

PO BOX 201601  
HELENA, MONTANA 59620-1601

### Scoping Notice:

The Montana Department of Natural Resources and Conservation (DNRC), Trust Land Management Division (TLMD) Helena Unit is currently reviewing an easement application from the City of Belgrade to construct an operations facility on State Trust Land located in Gallatin County administered by the DNRC-Bozeman Unit, near Penwell Bridge Road and Lagoon Road, east of Belgrade, MT. The location of the proposed public facility easement is on the State Trust Land parcel described below:

#### **Township 1 South, Range 4 East, Section 36**

The purpose of the proposed easement would be to provide the City of Belgrade an easement for a Public Works Facility to include: Administrative Facilities, Equipment Materials Storage, Passenger Vehicle and Light Equipment Maintenance, Stormwater Management Facility, Law Enforcement Processing, Storage and Compound, Materials Storage Bays, Equipment and Material Staging Area, Heavy Vehicle Storage and Maintenance Facility. The total acres to be encumbered by the easement is 28.173 acres. Please refer to the attached map.

This proposed easement is anticipated to be presented to the Montana State Board of Land Commissioners (Land Board) by January 2023. The proposed action would likely be implemented immediately contingent on the Land Board approval and the execution of the easement. The DNRC is in the scoping phase of the project environmental assessment. In preparation for this project, DNRC will be analyzing the impacts to the State Trust Land resulting from the proposal. The Montana DNRC invites comments and suggestions concerning this proposal from all interested parties. Please respond by end of business **09/23/2022** to:

Department of Natural Resources and Conservation  
Attn: Andy Burgoyne  
MT DNRC, Central Land Office  
8001 North Montana Ave  
Helena MT, 59602  
or: [JBurgoyne@mt.gov](mailto:JBurgoyne@mt.gov)

(or)

Department of Natural Resources and Conservation  
Attn: Erik Eneboe  
MT DNRC, Bozeman Unit Office  
2273 Boot Hill Court, Suite 110  
Bozeman MT, 59715  
or: [eeneboe@mt.gov](mailto:eeneboe@mt.gov)

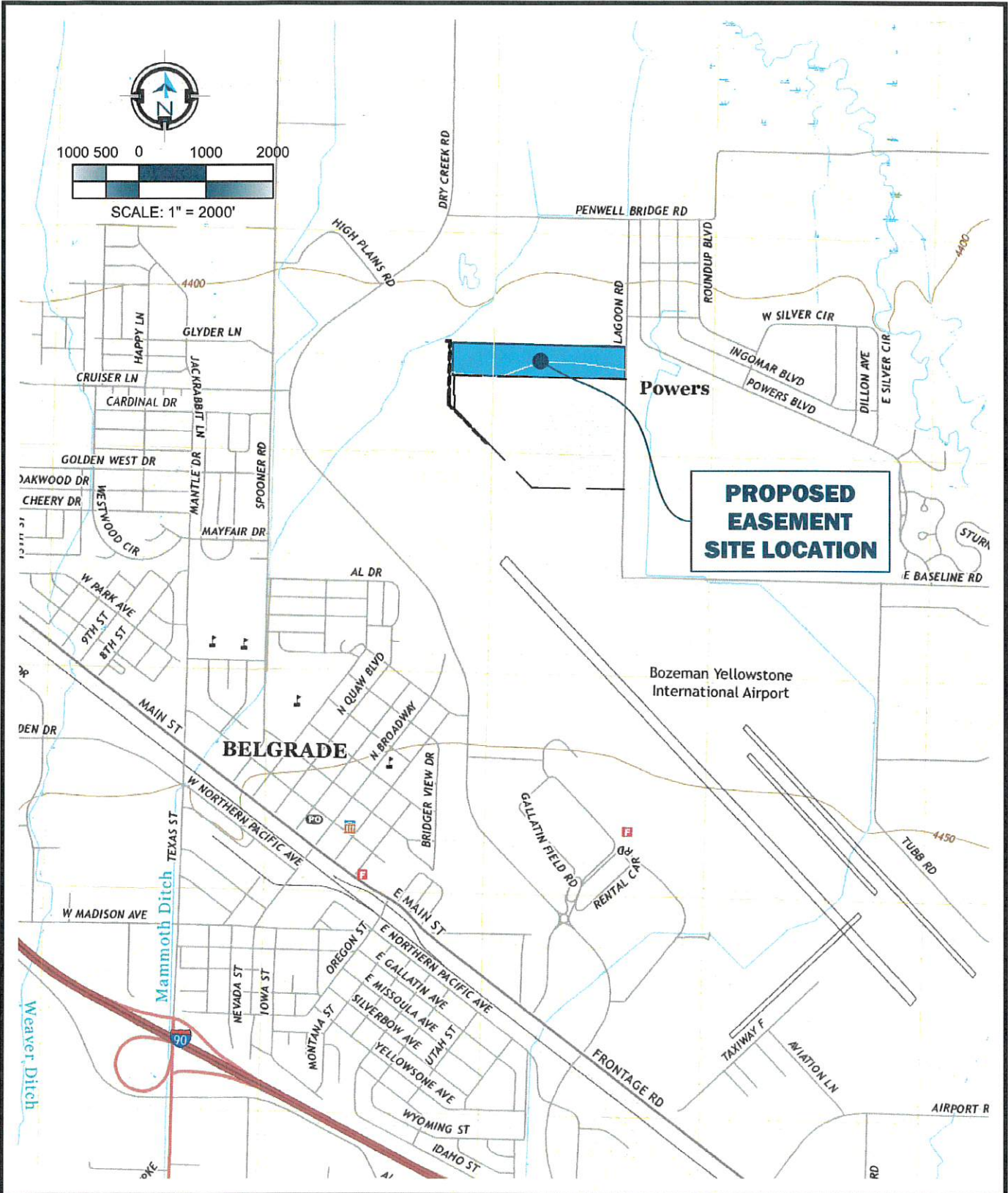

**PROPOSED CITY OF BELGRADE OPERATIONS  
CENTER MONTANA DNRC EASEMENT SITE**

USGS QUADRANGLE  
VICINITY MAP

DATE: 08/08/2022

DRAWN BY: TEE

REVIEWED BY: -

SCALE: 1" = 2000'

SHEET:

**EX-D**